

ADVERTISING SECTION
F
 New Homes for sale
 in the Seattle and
 Puget Sound Area.

New Homes

SATURDAY

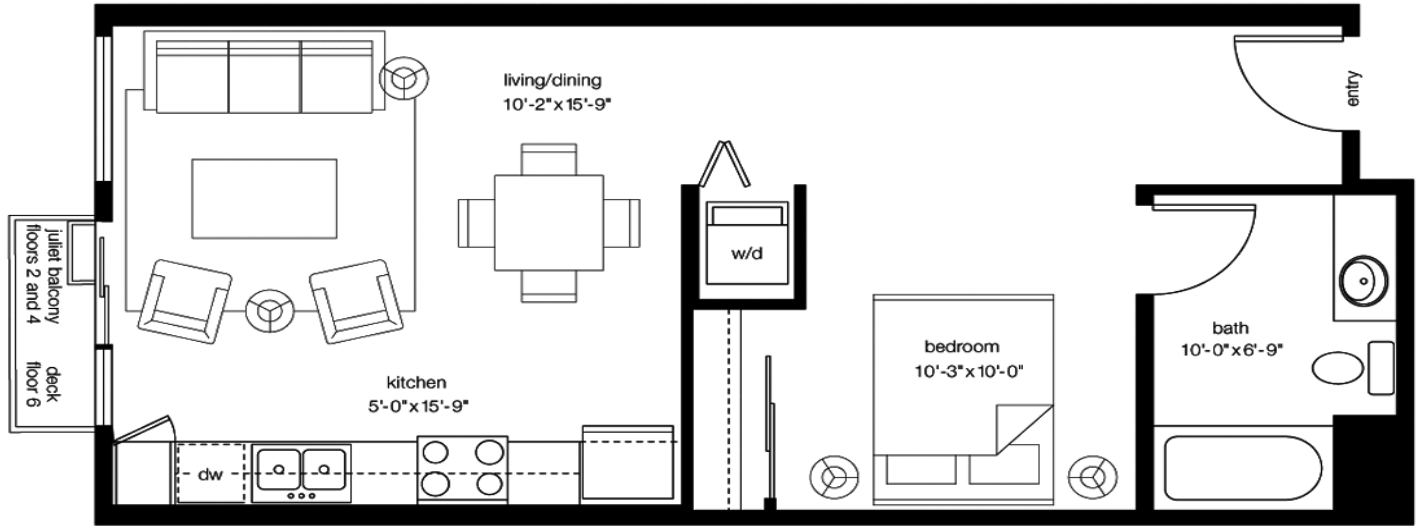

FLOOR PLAN OF THE WEEK | brix condominiums

The Belmont Series 1A plan at Brix Condominiums in Seattle's lively Capitol Hill neighborhood is an open one-bedroom, one-bath home designed to blend high-end interior finishes with every-day functionality. Brix's open one-bedrooms feature spacious and bright living spaces, high ceilings up to nine feet, kitchens that may offer movable islands, "Euro slider" doors for bedroom privacy and a variety of customizable options including hardwood floors throughout, air conditioning, electric blinds and custom multimedia systems. Located on levels two through six, these homes combine the best of interior design with a modern exterior that embraces the classic Northwest look. Brix's unique, "dual" building plan features distinct homes on both Broadway and 10th Avenue East that encircle a traditional Capitol Hill courtyard. Brix residents can also enjoy the large rooftop terrace that overlooks Broadway and features views of downtown Seattle, Puget Sound and the Space Needle.

PRICE

Belmont 1A plan priced from \$294,000 to 344,000.

SEE THIS HOME

The Brix Condominiums sales center is open daily from 11 a.m. to 5 p.m. at 700 Broadway Ave. E., at the corner of Roy Street and Broadway on Seattle's Capitol Hill. For more information or a private appointment, call 206-262-9416 or visit www.brixcondos.com.

DEVELOPER

Brix Condominium LLC.

